

VER	DESCRIPTION OF REVISIONS	DATE
A-0		2021/08/02

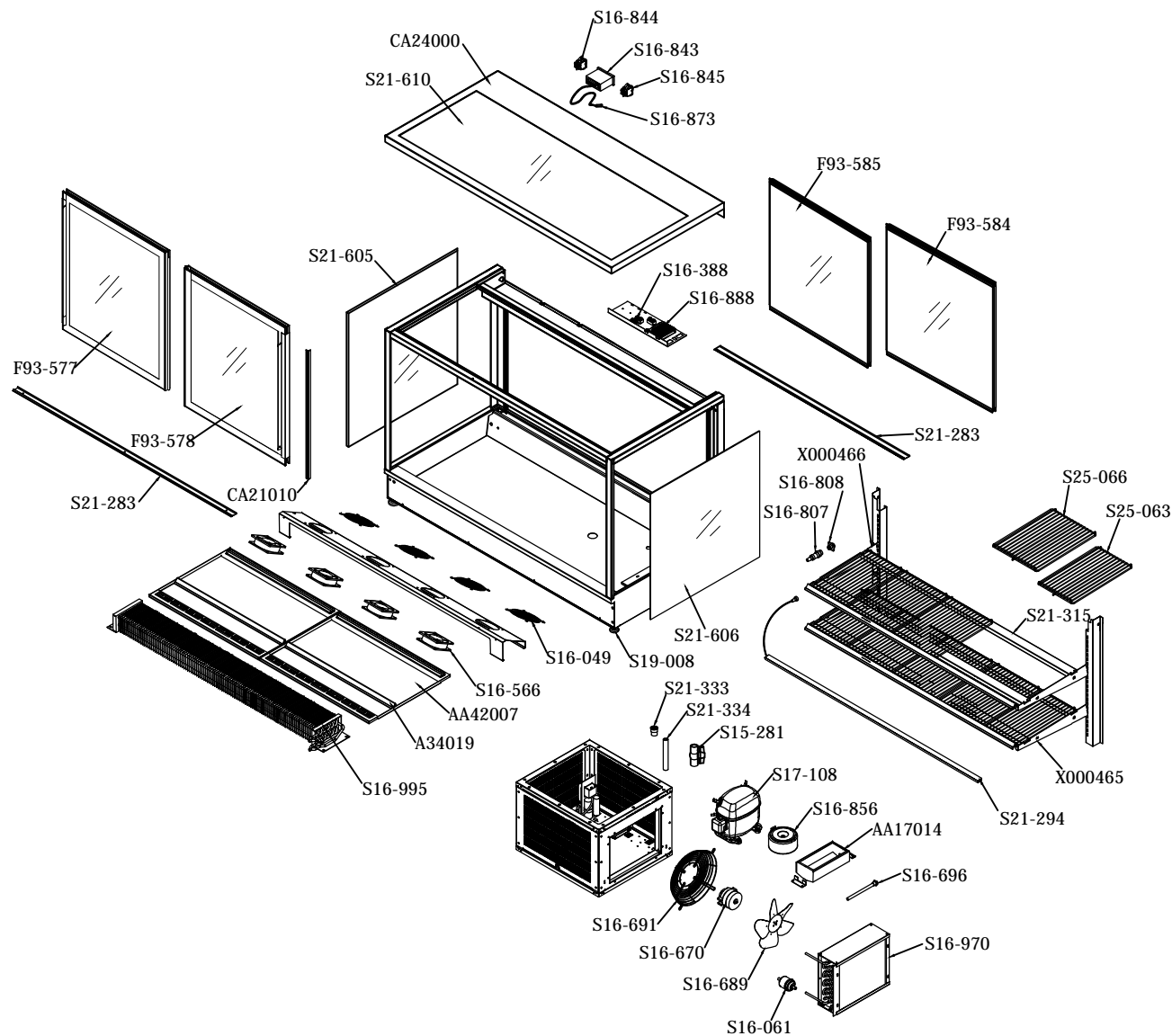

### Cossiga F93-191 STGRF15R(SD)

ID	Part No	Name	Spec	Unit	QTY	Note
1	CA24000	Top cover		PCS	1	
2	A34019	Ticket strips of deck		PCS	2	
3	AA17014	Evaporating pan with heater		PCS	1	
4	AA42007	Deck trays		PCS	2	
5	CA21010	Side glass frame		PCS	1	
6	F93-584	Rear Sliding Door - Left		PCS	1	
7	F93-585	Rear Sliding Door - Right		PCS	1	
8	S15-281	Plastic ball-valve		PCS	1	
9	S16-049	Fan guard	120X120	PCS	4	
10	S16-061	Filter	ELIMINATOR/DML-053S-3/8"	PCS	1	
11	S16-388	Terminal block	250VAC, 2.5MM2	PCS	3	
12	S16-566	Fan	SHENG KWEI-SK109AP-22-1	PCS	4	
13	S16-670	Fan motor	SP-B16HUEM2 (16W)	PCS	1	
14	S16-689	Fan blade	FV800CW30S38	PCS	1	
15	S16-691	Fan housing of motor	Φ230-80	PCS	1	
16	S16-696	Heater	190W	PCS	1	
17	S16-807	Plug	WS16J3TQ-C, WEIPU, 3P	PCS	2	
18	S16-808	Socket	WS16K3Z-C, WEIPU, 3P	PCS	3	
19	S16-843	Thermostat	Dixell XR06CX-5NOC1 240V/50HZ	PCS	1	
20	S16-844	Power supply button	22A 125/250VAC, Green	PCS	1	
21	S16-845	Lamp button	22A 125/250VAC, Yellow	PCS	1	
22	S16-856	Transformer	KT120-0400-1-01 240V-36V	PCS	1	
23	S16-873	Sensor	Dixell NG6 3M	PCS	1	
24	S16-888	power supply	LRS-75-12, 12V/6A	PCS	1	
25	S16-970	Condenser	350x288x122, Φ7	PCS	1	
26	S16-995	Evaporator	1300X95X175, Φ9.52	PCS	1	
27	S17-108	Compressor	SECOP, SC15MNX/R290	PCS	1	
28	S19-008	Plastic footing	M10*55	PCS	4	
29	S21-283	Door track		PCS	2	
30	S21-294	LED light	L=1300	PCS	3	
31	S21-315	LED extrusion	L=1387MM	PCS	4	
32	S21-333	Coupling pipe	20X1/2"	PCS	1	
33	S21-334	PVC pipe	DE20	PCS	0.1	
34	S21-605	Side glass		PCS	1	
35	S21-606	Side glass		PCS	1	
36	S21-610	Top glass	1426X399	PCS	1	
37	S25-063	Shelf	400X238	PCS	4	
38	S25-066	Shelf	400X300	PCS	6	
39	X000465	Crossbeam of shelf-right		PCS	1	
40	X000466	Crossbeam of shelf-left		PCS	1	
41	F93-577	Front Sliding Door - Left		PCS	1	
42	F93-578	Front Sliding Door - Right		PCS	1	